

SS10B / SS20S Light Weight Aluminum Speaker Stand

The Studiomaster Professional SS 10B & SS 20S are high quality, light weight & durable speaker stands that provide a perfect way to extend speaker coverage area.

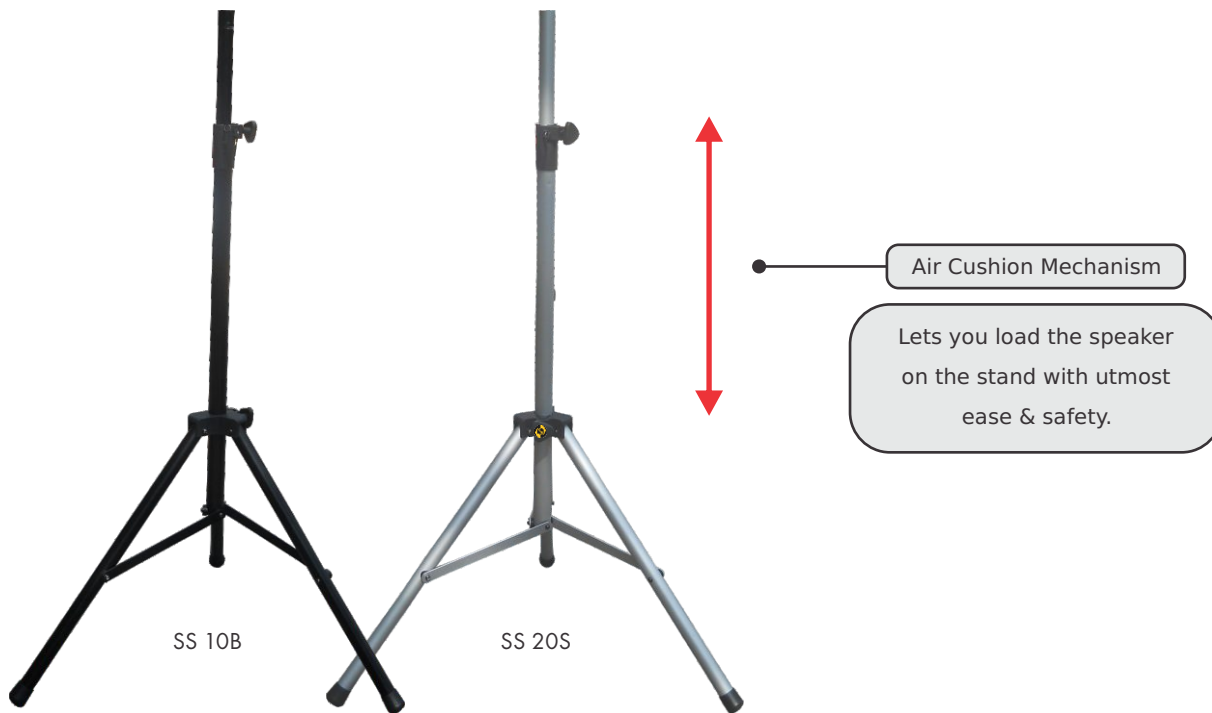

Features:

- High quality aluminum alloy speaker stand
- Air Cushion Mechanism for easy & safe speaker mounting.
- Light Weight & Durable.
- Locking Knob & Safety-Pin for extra safety.
- Anti-Skid Footcaps.

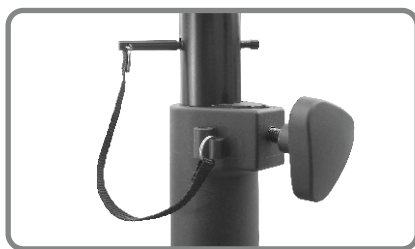

Locking Knob & Safety-Pin

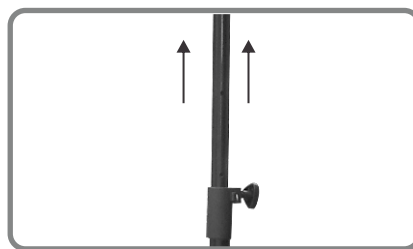

Max Height : 1.8Mtrs

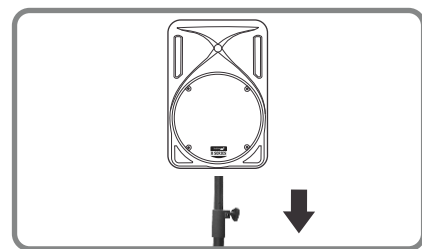

Load Capacity : 60 Kg

Technical Specifications:

Model	SS 10B	SS 20S
Type	Air Cushion Style	Air Cushion Style
Material	Aluminum Alloy	Aluminum Alloy
Color	Black	Silver (Gray)
Moving Tube	35 mm	35 mm
Center Tube	41.5mm	41.5mm
Load Capacity	60 kg	60 kg
Max Height	1.8 mtrs.	1.8 mtrs.